

# NAVIGATION

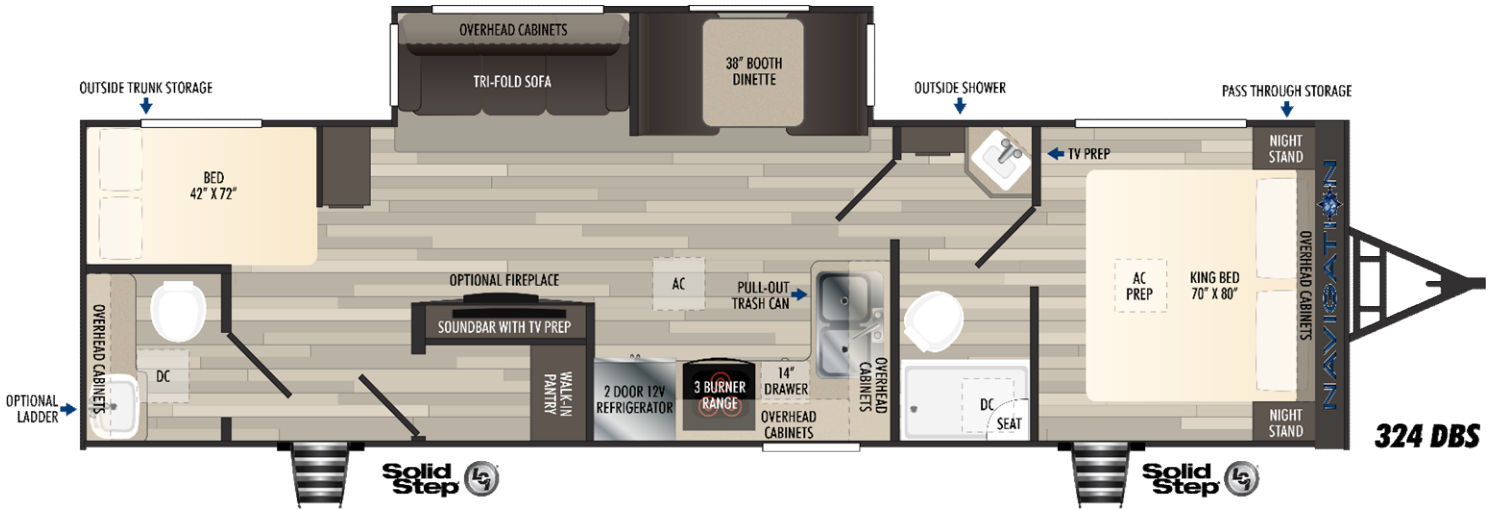

## Exterior Features

### Widebody 8.5'

2" X 4" Transverse Floor Joists 16" on Center

### 5/8" Tongue & Groove Plywood Flooring

2" x 2" Sidewall Construction 16" on Center

.030 Aluminum Mesa Exterior Siding

5" Engineered Roof Truss 16" on Center

3/8" Roof Decking W/EPDM Membrane Over Rafters

Pass-Thru Front Storage

### 32" Friction Hinge Main Entry Door

32" Lippert Solid Drop Down Step

### 50 AMP Service W/Detachable 25' Power Cord

Folding Entry Handle

Power Tongue Jack

## Interior Features

### 84" Interior Height

Residential Tri-Fold Sofa

38" Booth Dinette w/Bench Storage

### DVD Stereo Sound Bar

10.7 CU FT 12v Refrigerator

### Kitchen Pull-out Trash Can

Walk-in Pantry

### Residential King Bed 70x80 W/Storage

### Porcelain Foot Flush Toilet

### 1 pc. Fiberglass Shower

15,000 BTU Ducted AC

2nd AC Prep

### 40,000 BTU Floor Ducted Furnace

## Exterior Options

2 Pair Electric Stabilizer Jacks IPO Crank Down Jacks

Bumper Mount Spare Tire

Rear Ladder

Heated Holding Tanks

## Interior Options

Table W/4 Storage Chairs IPO Booth Dinette

Extra Dinette Chair (Ea)

LED Rope Light Package Kit & LR Per Floor Plan

30" Fireplace W/Remote

2nd 15,000 BTU A/C - Ducted

Fantastic Fan W/Remote IPO Ceiling Vent Fan

Dry Wgt	Hitch Wgt	GVWR	Ext Length	Ext Height
9,214	1,230	12,000	36	12' 2"

Fresh	Gray	Black	Water Htr	Awning
49 Gal	49 Gal	98 Gal	10 Gal G/E	21'

AC (s)	Furnace	Bed	# slides	Axles
15,000 BTU	40,000 BTU	70 x 80	1	6,000 lbs.

## Your Local Dealer: